

# W10IE3S-SPH2-B

## 10.1" Intel® Celeron® N6211 IP65 Stainless B Series Panel PC



### KEY FEATURES

- Intel® Celeron® Elkhart Lake N6211 processor
- Fanless cooling system
- SUS 316 / AISI 316 stainless steel for food and chemical industries
- A true flat, easy-to-clean front surface with edge-to-edge design
- Supports VESA mount
- Rotary switch adjust different touch mode for Hand / Rain / Glove application
- Emergency and Flat buttons for automation device control
- Optical bonding (optional)



### OVERVIEW



#### Waterproof All-Around

The Panel PC complies with IP65 water and dust resistance for regular cleanup processes and strict hygiene standards in the Food, Beverage, and Pharmaceutical industries.



#### Stainless B Series with Push Buttons

Push-buttons bring precise control directly to the work area, eliminating wasted movement and increasing productivity. Also, the physical buttons are especially useful for critical situations like emergency shutdowns.



#### Emergency Stop

When an emergency occurs, we don't want to waste time navigating through HMI screens; hence a button offers a quick and simple way to shut down the process.

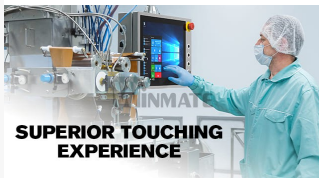

#### Ultimate Touch Experience

The highly-sensitive touch screen and PCAP multi-touch support make it easy for users to key in data, rotate images, drag and drop files, and zoom in with two or more fingers. The rotary switch gives a simple, intuitive way to switch hand, rain, and glove modes.

### SPECIFICATIONS

Display		System Specification	
<b>Resolution</b>	1280x800	<b>Size</b>	10.1 inches
<b>Contrast Ratio</b>	800:1	<b>Panel Brightness</b>	350.0 nits
<b>View Angles</b>	85,85,85,85	<b>Active Area</b>	216.96x135.6 mm
<b>Touch / Glass</b>	Projected Capacitive Multi Touch Screen		
<b>System Specification</b>			
<b>WLAN</b>	Support (Optional)	<b>BT</b>	Support (Optional)
<b>Processor</b>	Intel® Celeron® N6211 (up to 2.6GHz) Intel® Celeron® N6210 (up to 3.0GHz) (Optional)	<b>Memory</b>	1 x SO-DIMM, DDR4 3200 MHz, 4GB 8GB (Optional) 16GB (Optional)

<b>Storage</b>	1 x M.2 2242 B-key SSD 128GB M.2 2242 B-key SSD up to 512GB (Optional) 1 x SATA III for 2.5" SSD/HDD up to 1TB (Optional)	<b>Ethernet controller</b>	2 x Intel® Ethernet Controller
<b>Security</b>	TPM 2.0	<b>Operating System</b>	Windows 11 IoT Enterprise SAC (64 bit) (Optional) Windows 11 Pro 64 bit (Optional) Windows 10 IoT Enterprise (64 bit) (Optional) Linux Ubuntu 22.04 (Optional)
<b>Mechanical</b>			
<b>Dimension</b>	293 x 250 x 69 mm	<b>Mounting</b>	VESA Mount
<b>Enclosure</b>	Stainless Housing	<b>Cooling System</b>	Fanless design
<b>Environment</b>			
<b>Operating Humidity</b>	10% to 90% RH, Non-Condensing	<b>Operating Temperature</b>	0°C to 45°C
<b>Storage Temperature</b>	-20°C to 60°C	<b>IP rating</b>	IP65
<b>Certification</b>			
<b>Certification</b>	CE, FCC		
<b>IO Ports</b>			
<b>Power Input</b>	1 x M12 waterproof connector for 12V DC	<b>USB Port</b>	1 x M12 waterproof connector for 1 x USB2.0 & Giga LAN
<b>Serial Port</b>	1 x M12 waterproof connector for RS232	<b>Expansion Port</b>	CN1 and CN2 for front button control
<b>Indicator</b>	1 x LED Indicator for power 1 x LED Indicator for storage		
<b>Control</b>			
<b>Button</b>	Rear side: 1 x Power Button 1 x Reset Button Front side: 1 x Emergency Button & 3 x Flat Button for CN1 & CN2 M12 connector 1 x Rotary Switch for touch mode		
<b>Accessory</b>			
<b>Accessory</b>	100~240V AC to DC Adapter with waterproof connector Power Cord External USB & LAN cable with waterproof connector External COM cable with waterproof connector External cables for CN1 & CN2 with waterproof connector Waterproof caps RJ45 female-female converter VESA screws	<b>Optional Accessory</b>	1 x Open wire cable for M12 connector
<b>Power</b>			
<b>Power Rating</b>	M12 Type: 12V DC 9~36V DC (Optional)		

## DIMENSIONS UNIT:MM

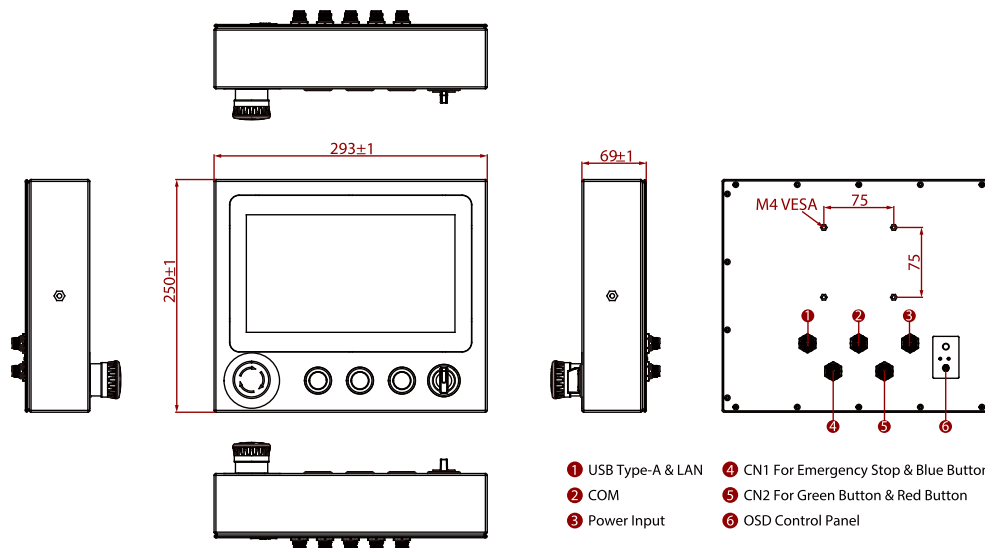

## NOTE

1. This is a simplified drawing and some components are not marked in detail.
2. Please contact our sales representative if you need further product information.
3. All specifications are subject to change without prior notice.
4. The product shown in this datasheet is a standard model. For diagrams that contain customized or optional I/O, please contact the Winmate Sales Team for more information.

## Assured Systems

Assured Systems is a leading technology company with over 1,500 regular clients in 80 countries, deploying over 85,000 systems to a diverse customer base in 12 years of business. We offer high-quality and innovative rugged computing, display, networking and data collection solutions to the embedded, industrial, and digital-out-of-home market sectors.

### US

[sales@assured-systems.com](mailto:sales@assured-systems.com)

Sales: +1 347 719 4508  
Support: +1 347 719 4508

1309 Coffeen Ave  
Ste 1200  
Sheridan  
WY 82801  
USA

### EMEA

[sales@assured-systems.com](mailto:sales@assured-systems.com)

Sales: +44 (0)1785 879 050  
Support: +44 (0)1785 879 050

Unit A5 Douglas Park  
Stone Business Park  
Stone  
ST15 0YJ  
United Kingdom

VAT Number: 120 9546 28  
Business Registration Number: 07699660