



Multi-Port RS-232/422/485 PCI Express M.2 Card Datasheet

MODELS M.2-COM-4SM, M.2-COM-4S, M.2-COM232-4 AND M.2-COM-2SM, M.2-COM-2S, M.2-COM232-2

FEATURES

- M.2 CARD 2260/2280 SIZE, WITH LATCHING I/O CONNECTORS
- FOUR AND TWO-PORT MPCIE SERIAL CARDS WITH OPTIONAL DB9M CONNECTIVITY
- FOUR SOFTWARE SELECTABLE SERIAL TYPES: RS-232, RS-422, AND RS-485 (2WIRE & 4WIRE)
- "SM" MODELS SUPPORT ALL 3 SERIAL TYPES. "S" MODELS SUPPORT RS-422 AND RS-485
- HIGH PERFORMANCE 16C950 CLASS UARTS WITH 128-BYTE FIFO FOR TX AND RX BUFFERING
- SUPPORTS DATA COMMUNICATION RATES TO 921.6KBPS IN RS232 – AS HIGH AS 3MBPS IN DIFFERENTIAL MODES – 10MHZ WITH CUSTOM CRYSTAL OPTION
- PORT-BY-PORT FIELD SELECTABLE TERMINATION FOR RS422 & RS485 APPLICATIONS
- VIRTUALLY ANY CUSTOM BAUD RATE MAY BE CONFIGURED BY THE USER VIA REGISTER SETTINGS, NO CUSTOM OSCILLATOR NEEDED
- ±15KV ESD PROTECTION ON ALL SIGNAL PINS
- SUPPORTS CTS, RTS, 9-BIT DATA MODE, HALF-DUPLEX AND FULL-DUPLEX COMMUNICATIONS
- ROHS AND INDUSTRIAL TEMP (-40°C TO 85°C) BOTH STANDARD



FUNCTIONAL DESCRIPTION

The M.2-COM-4SM family of cards feature high performance 16C950-class UARTs. Available in 4-port and 2-port versions, each port is capable of communication speeds up to 921.6kbps in RS-232 (differential modes support speeds as high as 3Mbps) and has 128-byte deep transmit and receive FIFOs. Large FIFOs protect against data loss in multitasking operating systems, reduce CPU utilization, and improve data throughput, while reducing or eliminating inter-character or inter-packet pauses. The advanced integrated circuit with pre-scaler supports a wide variety of custom baud rates, and any rates not otherwise achievable can be supported via a custom factory-installed crystal oscillator (up to 10Mbps!).

RS-232, RS-422, or RS-485 can be software selected, per port, and the selection is stored in non-volatile memory for future use. If you don't need that much flexibility you can order versions with only RS422/485 or even pure RS232. The RS232 ports provided by the card are 100% compatible with every other industry-standard serial COM device, supporting TX, RX, RTS, and CTS. RS422 mode uses the same transceivers as the RS-485 specification, allowing perfect 4-wire RS-422 and RS-485 compatibility – and the device supports full-duplex RS-485 4-wire.

The serial ports on the device are accessed using a low-profile, latching, 6-pin Hirose connector. Optional breakout cables are available, and bring each port connection to a panel-mountable DB9-M connector.

SPECIAL ORDER

Please contact ACCES with your precise requirement. Examples of special orders would be custom oscillators, conformal coating, custom software or product labelling, and more. We will work with you to provide *exactly* what is required.

ACCESSORIES

Available accessories include:

- CAB-M.2-COM2** Two port DB-9 cable accessory kit
- CAB-M.2-COM4** Four port DB-9 cable accessory kit
- ADAP-9** DB-9 Screw Terminal Accessory
- M.2-HDW-KIT2** 2mm mounting hardware

SOFTWARE

A complete driver support package is provided including an easy-to-use Windows terminal program for testing your COM ports. This simplifies the verification of proper COM port operation. The card installs as standard COM ports in all operating systems including DOS, Linux (including Mac OS X) and 32-bit and 64-bit Windows. Additional drivers may be available for a wide variety of operating systems including Windows CE, please contact the factory for compatibility with your specific OS. ACCES is also now offering a VxWorks driver/library for the ultimate real-time process monitoring and control solution.

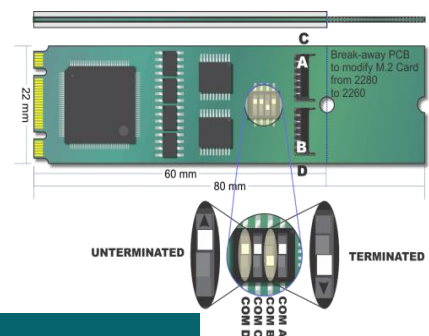

ACCES
I/O PRODUCTS, INC.

Multi-Port RS-232/422/485 PCI Express M.2 Card Datasheet

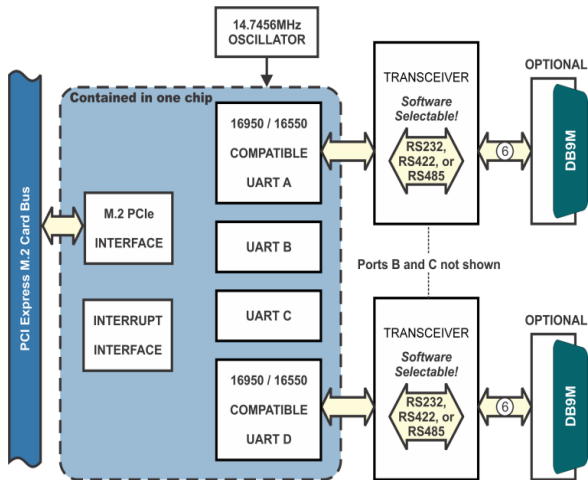

Mating

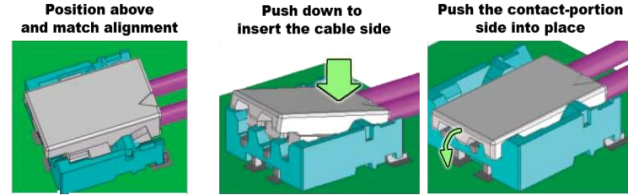

Un-Mating



Physical

Weight	6.0 grams
Size	Length 60mm/80mm
	Width 22mm

PC Interface

M.2 Card	2260/2280 size
----------	----------------

Communications Interface

Connector	I/O Hirose DF57-6P-1.2V 6-pin, latching
	Mating Hirose DF57H-6S-1.2C
Serial Ports	4 (or 2)
software selected	-4SM (-2SM) RS-422, RS-485, and RS-232
serial type	-4S (-2S) RS-422 and RS-485
(per port, stored in EEPROM)	232-4 (232-2) RS-232 only
UART	Quad 16C950
	FIFO 128-byte transmit & receive
Baud Rates	up to 921.6k baud in RS-232 up to 3MBaud in differential modes advanced-prescaler allows a wide variety of unusual baud rates to be achieved. Up to 10Mbps via custom crystal option
Character length	5, 6, 7, 8 bits (contact factory for assistance with 9-bit data)
Parity	Even, Odd, None, Mark, Space
Stop Interval	1, 1½, 2 bits
Flow Control	RS-232 RTS/CTS, Xon/Xoff, None
	RS-422, RS-485 Xon / Xoff, None

DB-9 Male Pin	232	422	485
1			Tx-
2	RX	Rx+	Rx/Tx+
3	TX	Rx-	Rx/Tx-
4	RTS ¹	Rx-	Rx/Tx-
5	GND	GND	GND
6			
7	RTS	Rx ⁻¹	
8	CTS		
9			

Note 1: pin 4 and pin 7 are connected.

Signal Definitions	
Signal	Meaning
	no connect
RX	Receive Data
TX	Transmit Data
GND	Signal Ground
RTS	Request To Send
CTS	Clear To Send
Tx-	Diff. full-duplex TX -
Tx+	Diff. full-duplex TX+
Rx+	Diff. full-duplex Rx+
Rx-	Diff. full-duplex Rx-
Rx/Tx+	Diff. half-duplex +
Rx/Tx-	Diff. half-duplex -

Pin 4 and pin 7 are connected, so these signals are duplicates to be ignored.

Hirose 6-pin	232	422	485
1	GND	GND	GND
2	Tx	Rx+	Rx/Tx+
3	Rx	Tx+	
4	RTS	Rx-	Rx/Tx-
5	CTS		
6		Tx-	

DSub 9-pin Male

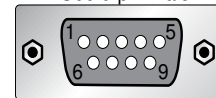

Environmental

Temperature	Operating	-40° to 85°C
	Storage	-65° to 150°C
Humidity		5% to 95%, non-condensing
Power required		+3.3VDC @ 1.6W (typical)
ESD Protection		±15kV on all signal pins (IEC 61000)

ORDERING GUIDE

M.2-COM-4SM	4-port, RS-232, -422, and -485 M.2 Card
M.2-COM-2SM	2-port, RS-232, -422, and -485 M.2 Card
M.2-COM-4S	4-port, RS-422, and -485 M.2 Card
M.2-COM-2S	2-port, RS-422, and -485 M.2 Card
M.2-COM232-4	4-port RS-232 M.2 Card
M.2-COM232-2	2-port RS-232 M.2 Card

SHIPS STANDARD WITH INDUSTRIAL OPERATING TEMPERATURE AND ROHS

Assured Systems

Assured Systems is a leading technology company with over 1,500 regular clients in 80 countries, deploying over 85,000 systems to a diverse customer base in 12 years of business. We offer high-quality and innovative rugged computing, display, networking and data collection solutions to the embedded, industrial, and digital-out-of-home market sectors.

US

sales@assured-systems.com

Sales: +1 347 719 4508
Support: +1 347 719 4508

1309 Coffeen Ave
Ste 1200
Sheridan
WY 82801
USA

EMEA

sales@assured-systems.com

Sales: +44 (0)1785 879 050
Support: +44 (0)1785 879 050

Unit A5 Douglas Park
Stone Business Park
Stone
ST15 0YJ
United Kingdom

VAT Number: 120 9546 28
Business Registration Number: 07699660