

# MVS100-323-FL NEW

Mini Vision System with Intel® Atom® x5-E3940 Processor, Vision I/O, 2-CH PoE and 2-CH LED Output

## Features

- Integrated real-time vision I/O
  - 2-CH trigger input
  - 2-CH trigger output
  - 2-CH LED lighting control
  - 4-CH isolated DIO
- Supports camera interfaces
  - 2 IEEE802.3af GbE LAN ports (PoE)
- Power input: 24 VDC
- -10°C to +55°C operating temperature range
- Supports TPM 2.0 function



## Specifications

Standard Color	Black
Construction	Extruded aluminum and heavy-duty steel, IP40
Processor System	Intel® Atom® x5-E3940 processor (1.6GHz)
System Memory	1 x DDR3L SO-DIMM, up to 8GB
System I/O	1 x Power Switch 1 x 3-pin terminal block (power input) 1 x 10/100/1000 Mbps Ethernet (Intel® i211-AT) 1 x RS-232/422/485 2 x USB 3.2 Gen1 1 x HDMI 1 x VGA 1 x Internal USB connector (optional)
TPM	TPM 2.0
Vision I/O	- 2-CH trigger input (dry or wet contact, sink/source type, input range: 0 to 30V)* - 2-CH trigger output (sink type, open collector, output range: 0 to 30V, 100mA max./CH)** - 2-CH LED lighting control (12V/24V, max. 0.5A per CH) - 2-CH isolated DI (dry or wet contact, sink/source type, input range: 0 to 30V) - 2-CH isolated DO (sink type, open collector, supply voltage: 5-30V, 100mA max./CH) - Programmable interrupt functions

\*Trigger Input can be configured to DI independently by API  
\*\*Trigger Output can be configured to DO independently by API

Camera Interface	2 x IEEE802.3af GbE LAN port (PoE, Intel® i210-AT, IEEE802.3af compliant, total max. power output 20W)
Storage	1 x Full-size PCI Express Mini Card slot (mSATA signal)
System Indicators	1 x Power LED 1 x HDD LED 2 x PoE power LED
Power Input	Type: ATX/AT Input: 24 VDC±10%
Operating Temperature	-10°C to +55°C (+14°F to +131°F)
Storage Temperature	-20°C to +80°C (-4°F to +176°F)
Humidity	10% to 95%, non-condensing
Dimensions	53.2 mm (2.09") (W) x 155 mm (6.1") (H) x 110.3 mm (4.34") (D)
Weight (net/gross)	0.6kg(1.32lb)/0.9kg(1.98lb)
Certifications	CE, FCC
Software Support	AMS.AXView

### Ordering Information

System	
MVS100-323-FL (P/N: E27L100100)	Mini vision system with Intel® Atom® x5-E3940 processor, vision I/O, 2-CH PoE and 2-CH LED output

### Power Protection

DC Version
OVP (over voltage protection)
SCP (short circuit protection)
OCP (over current protection)

### Packing List

- 1 x MVS100-323-FL
- 1 x Screw pack
- 3 x Terminal block
- 1 x DIN-rail kit

### Dimensions

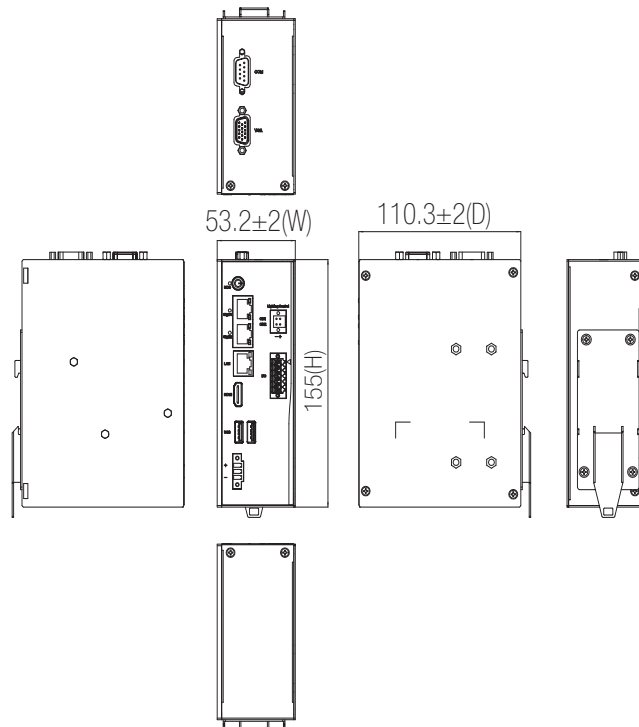

\* All specifications and photos are subject to change without notice. [www.axiomtek.com](http://www.axiomtek.com) © 2021 Axiomtek Co., Ltd. All rights reserved.

1
2
3
4
5
6
7
8
9
10

Machine Vision Systems

## Assured Systems

Assured Systems is a leading technology company with over 1,500 regular clients in 80 countries, deploying over 85,000 systems to a diverse customer base in 12 years of business. We offer high-quality and innovative rugged computing, display, networking and data collection solutions to the embedded, industrial, and digital-out-of-home market sectors.

### US

[sales@assured-systems.com](mailto:sales@assured-systems.com)

Sales: +1 347 719 4508  
Support: +1 347 719 4508

1309 Coffeen Ave  
Ste 1200  
Sheridan  
WY 82801  
USA

### EMEA

[sales@assured-systems.com](mailto:sales@assured-systems.com)

Sales: +44 (0)1785 879 050  
Support: +44 (0)1785 879 050

Unit A5 Douglas Park  
Stone Business Park  
Stone  
ST15 0YJ  
United Kingdom

VAT Number: 120 9546 28  
Business Registration Number: 07699660